

SIRINGHE AUTOMATICHE SOCOREX® ULTRA 1810

Guida Rapida

Posizionamento del corpo

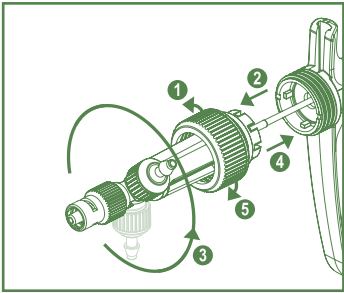

Regolare il posizionamento del corpo.

Attivazione (priming)

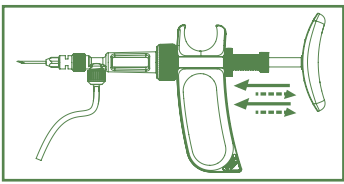

Attivare per aspirare ed espellere il liquido.

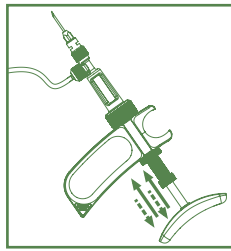

Rimuovere le bolle d'aria.

Valvole ostruite

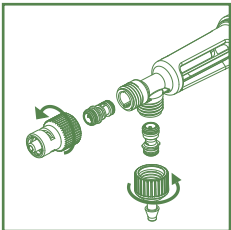

Svitare e lavare le valvole. Non inserire alcun utensile all'interno delle cartucce delle valvole.

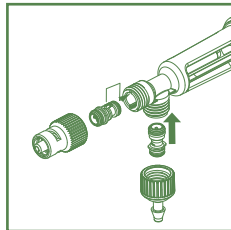

Assemblare nuovamente secondo la codifica meccanica.

Depurazione e risciacquo

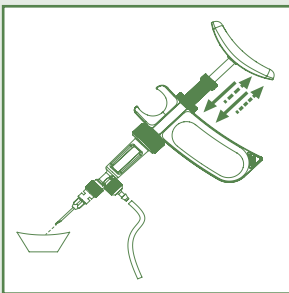

Recuperare il vaccino. Risciacquare con acqua/detergente.

Smontaggio e pulizia

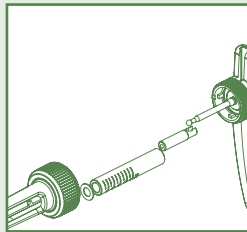

Svitare il dado e separare le parti. Pulire e asciugare le parti.



Montaggio

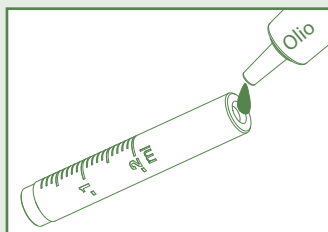

Lubrificare l'ingresso del fusto.

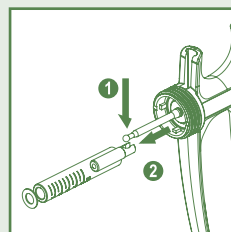

Montare il pistone nel fusto. Collegare l'asta.

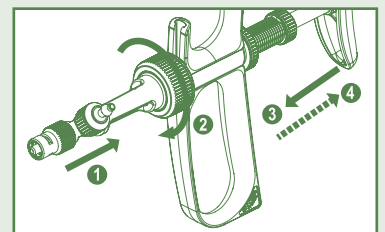

Collegare il corpo nella posizione premuta.



I.GUIDE.1810.I - D0223

SOCOREX
SWISS

Socorex Isba SA - Svizzera - www.socorex.com
Tel. +41 21 651 6000 - socorex@socorex.com

CERTIFIED
ISO 9001/13485
QM SYSTEM

Installazione del tubicino

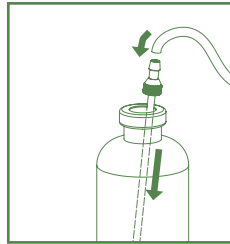

Inserire l'ago di alimentazione. Collegare il tubicino.

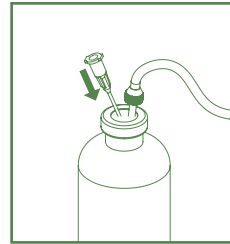

Inserire la cannula di sfiato.

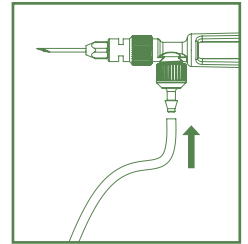

Collegare il tubicino alla siringa.

Impostazione del volume

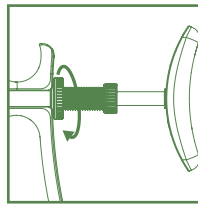

Sbloccare.

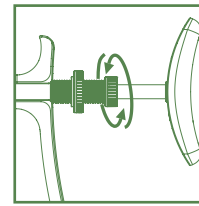

Ruotare il raccordo per muovere il pistone.

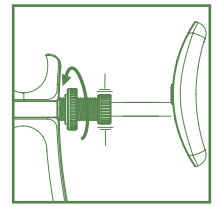

Tenere il raccordo e serrare.

Letture del volume

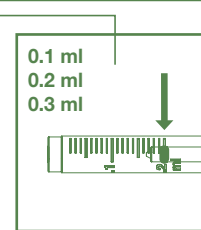
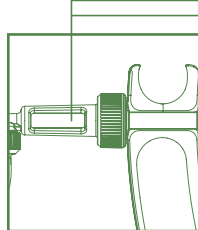

O-ring centrato sulla scala graduata.

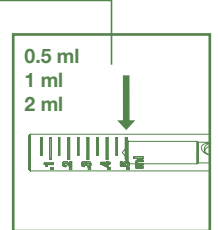

Estremità del pistone sulla scala graduata.